

Type Gearbox:

SCANIA transmissions GR-GRS-GRSO

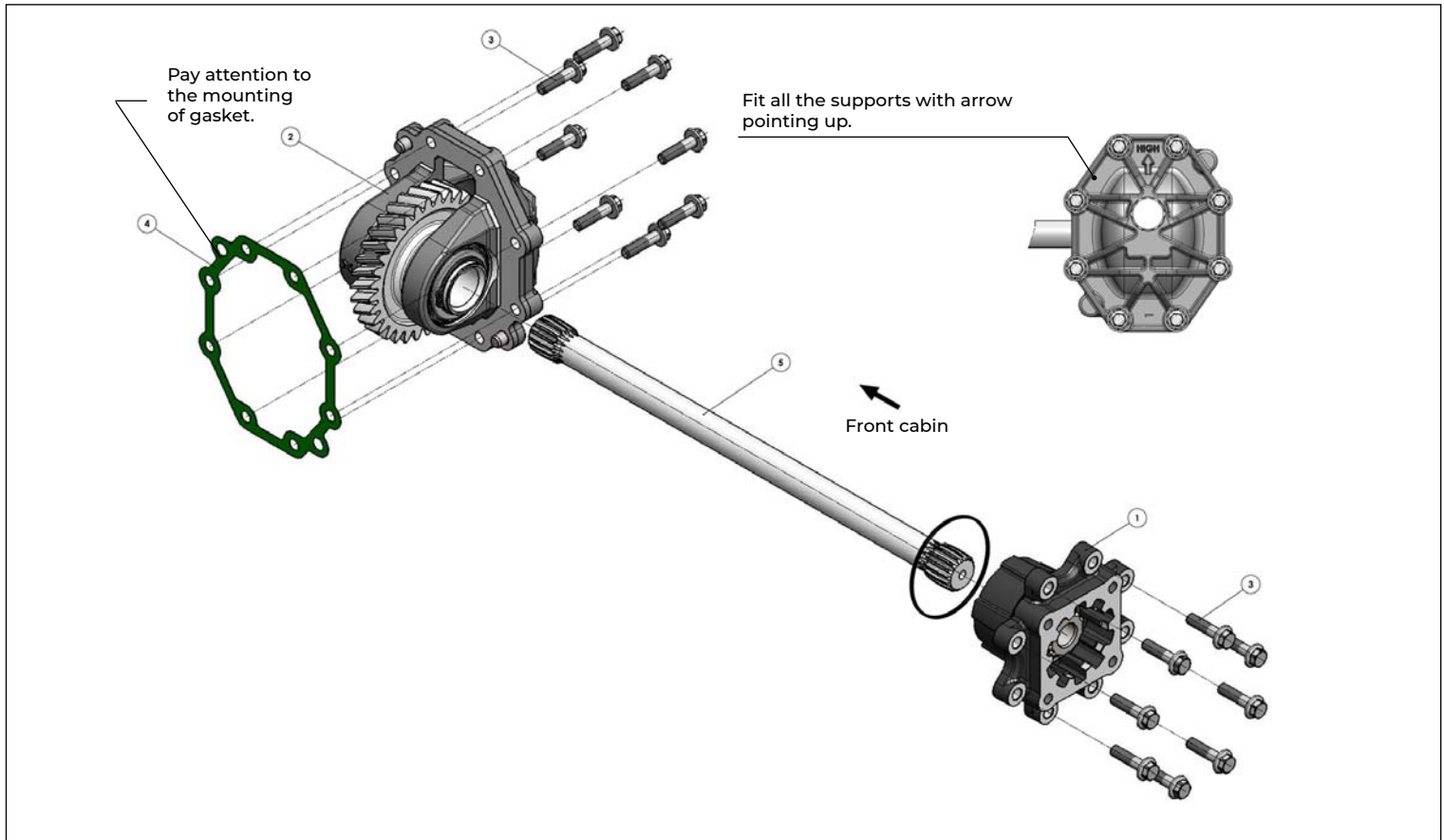

Specifications

Scania Gearbox	GR 875 - GRS 895
KIT code	021411102
Scania OEM PTO code	EG 651 P
Ratio	1.28/1.58
Torque	700 Nm

note:

PTO is not included with the adaptor kit. Refer to PTO INDEX for selecting high-power PTO model compatible with the adaptor or contact Hyva.

General Info

Due to patent pending the adaptor PTO's cannot be sold and used in the following Countries: Germany, France, UK, Sweden and Brazil.

Related documentation

Mounting instructions: PTO-0031